

CUSTOMER NAME: \_\_\_\_\_  
 ACK No: \_\_\_\_\_  
 SALESMAN: \_\_\_\_\_  
 L/H or R/H TO OPEN FIRST: \_\_\_\_\_  
 SPECIAL INSTRUCTIONS: \_\_\_\_\_

DO NOT SCALE - IF IN DOUBT ASK

JACKSONS RESERVE THE RIGHT TO CHANGE THE STANDARD DESIGN TO IMPROVE THE PRODUCT AT ANY TIME

NOTES.

ALL DIMENSIONS ARE IN mm (U.N.O)  
 GAP UNDERNEATH GATES IS BASED UPON THE SITE BEING LEVEL.

Materials.

GATE POSTS - 150 x 150 x 4 RHS

Finish.

GALVANISED TO BS EN ISO 1461:1999  
 TIMBER: JAKCURED

GATES CAN BE SUPPLIED WITH OPTIONAL FITTINGS PACK, WHICH INCLUDES:

- RING LATCH
- DROPBOLTS + RECEIVERS
- STOP POSTS + CABIN HOOKS
- CENTRE GATE STOP

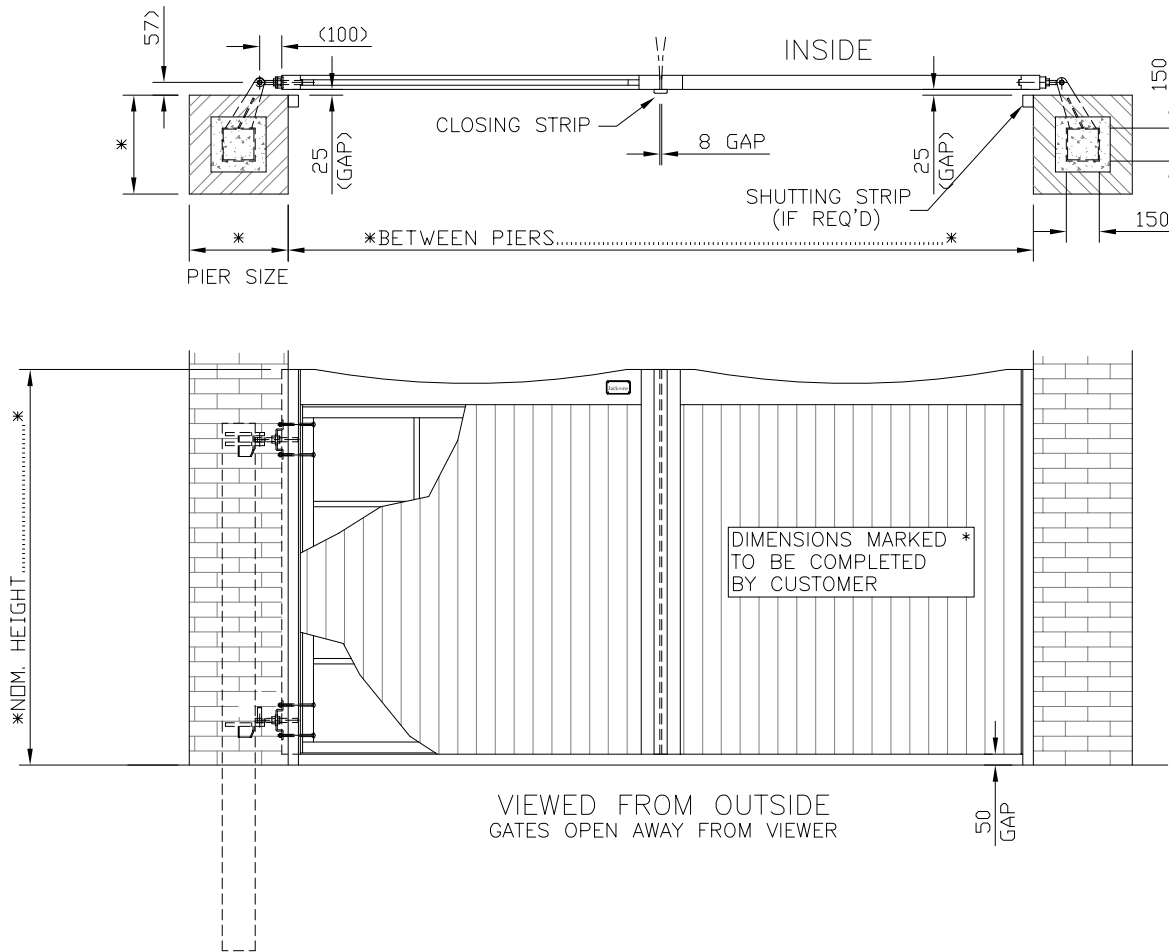

JACKSONS ACCEPT NO RESPONSIBILITY FOR THE STRENGTH & INTEGRITY OF THE PIERS

NEW BRICK PIERS TO BE BUILT AROUND GATE POSTS AFTER INSTALLATION. IT IS RECOMMENDED TO FILL PIER CAVITY & POST WITH CONCRETE FOR EXTRA STRENGTH

**Jacksons**  
**FINE FENCING**

Stowting Common  
 Near Ashford,  
 KENT. TN25 6BN  
 Telephone : 01233 750393  
 Fax: 01233 750403  
 Int. Tel : +44 (0)1233 750393

- ④ 15/12/09 S/STRIP GAP 25mm
- ③ 26/08/09 CGS NOT OAK/TXT
- ② 18/01/07 BOTTOM HINGE
- ① 13/06/06 HINGE WASHER PLATES
- ① 10/01/06 ORIGINAL ISSUE

Drawn WB  
 Date 10/01/06  
 Checked  
 Size A3  
 Scale N.T.S  
 U.O.S

TITLE SALES DRAWING FOR SANDWICH  
 COURTYARD GATES WITH POSTS IN PIERS  
 CUSTOMER  
 Drawing No. J7/02133  
 ACK No.  
 Sheet 3 of 3