

How to install Jakoustic Plus (absorptive) Fencing.

Thank you for choosing Jacksons Fencing. Our high quality fencing products will last for years and give you trouble-free service if you follow the installation instructions below, which are offered as a general guide.

Follow standard installation instructions with the addition of the following on completion of Jakoustic installation (see dwg J704177).

1. Identify which side of the fence is to be fitted with absorptive. Generally this is the side with the noise source. If this is the post side, then the horizontal Rockwool support battens will have to be cut to suit between the posts. If on the flat side of Jakoustic highway, ensure that every horizontal batten is secured through to the nail battens using timberlok screws, driving heads below surface (where they cross) - THIS IS IMPORTANT & REPLACES COVER STRIP. If on the flat side of the fencing the battens can be continuous.
2. Fit horizontal Rockwool support battens (45x54mm) across fence bay ensuring they are fixed to the side of fence requiring acoustic absorption, using 75mm nails. Support battens to be fitted upwards at 650mm centres, 54mm to view; ensuring bottom batten is 50mm above ground level.
3. 1000x600mm Rockwool pieces to be placed tightly between each pair of support battens with an additional infill piece to the end, cut to suit (if req'd).
4. Measure the distance from the top of the top board down to the bottom of the bottom batten. Add 250mm to get your membrane cut length. Cut membrane carefully, making sure cut is square.
5. The counter rail on absorptive side is 70 x 54 planed - this replaces the 70x35 counter rail. Using the 70x54 counter rail to trap the membrane in position, screw to top board as counter rail. The top row of Rockwool will need to be cut to suit the gap between top batten & counter rail.
6. Drop the membrane down the front of the fence & trap the base of the membrane behind a horizontal 45x54 timber batten, which is nailed under the existing bottom batten. 2no drops of membrane per bay have been allowed.
7. The fence is then finished using Ø50mm half-round battens. These are nailed vertically to the horizontal battens (2" nails) at nom. 200mm centres. Make sure the vertical joints between adjacent drops of membrane are covered neatly. Any joints between Ø50 half-rounds must be made on a horizontal batten with both ends fixed, preferably at high level.

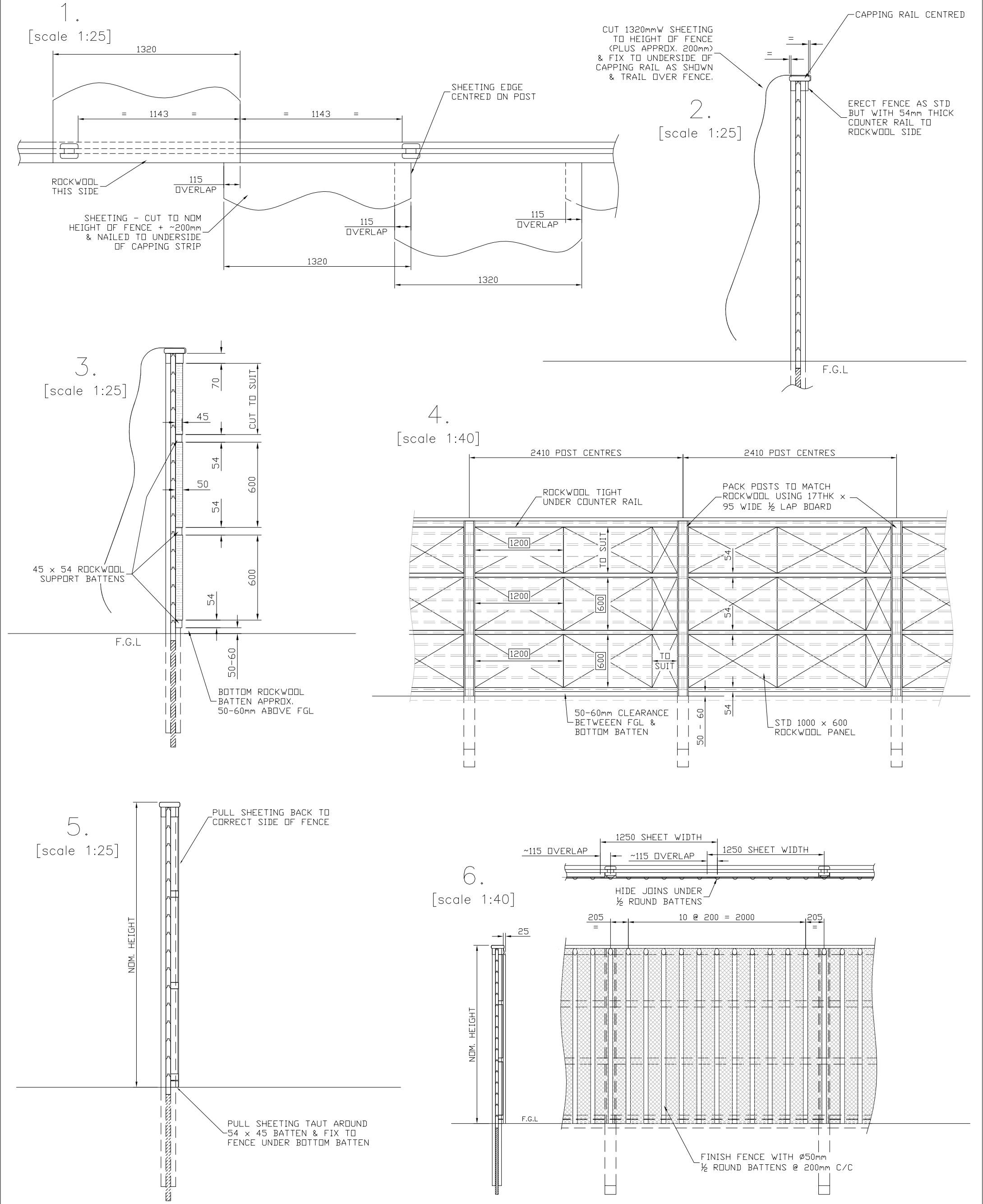

Drawn	JR	Checked	AT	2	17/11/10	batten updated
Date	10/01/08	Size	A3	1	20/07/10	Rockwool sizes
		Scale	NTS U.O.S	0	10/01/08	ORIGINAL ISSUE

Jacksons

FINE FENCING

Stowting Common, Near Ashford,
KENT. TN25 6BN

Telephone : 01233 750393
Fax: 01233 750403
Int. Tel : +44 (0)1233 750393

This Drawing Is The Property Of H.S. Jackson & Son (Fencing) Ltd.
And May Not Be Copied Or Reproduced In Any Way Without Prior Written Permission.

DO NOT SCALE – IF IN DOUBT ASK	
TITLE	ABSORBTIVE MODIFICATION TO JAKOUSTIC FENCING
CUSTOMER	Drawing No. J7/04177
ACK No.	